

N=800

E=200

3

Ufficio Provinciale di Verona - Territorio Servizi Catastali - Direttore EUGENIO DEMETRIO ROMEO

Vis. tel. (0.90 euro)



1 Particella: 143

Comune: VIGASIO  
Foglio: 24

Scala originale: 1:2000  
Dimensione cornice: 534.000 x 378.000 metri

12-Ago-2014 10:34  
Prot. n. T30282/2014



# NUOVO CATASTO EDILIZIO URBANO

(R. DECRETO-LEGGE 13 APRILE 1949, N. 652)

Li  
3.

Planimetria dell'immobile situato nel Comune di VIGASIO Via TREVENZUOLO 4/F

Ditta EDIMVEST S.p.A. CON SEDE IN VIGASIO (VR)

Allegata alla dichiarazione presentata all'Ufficio Tecnico Erariale di VERONA

4

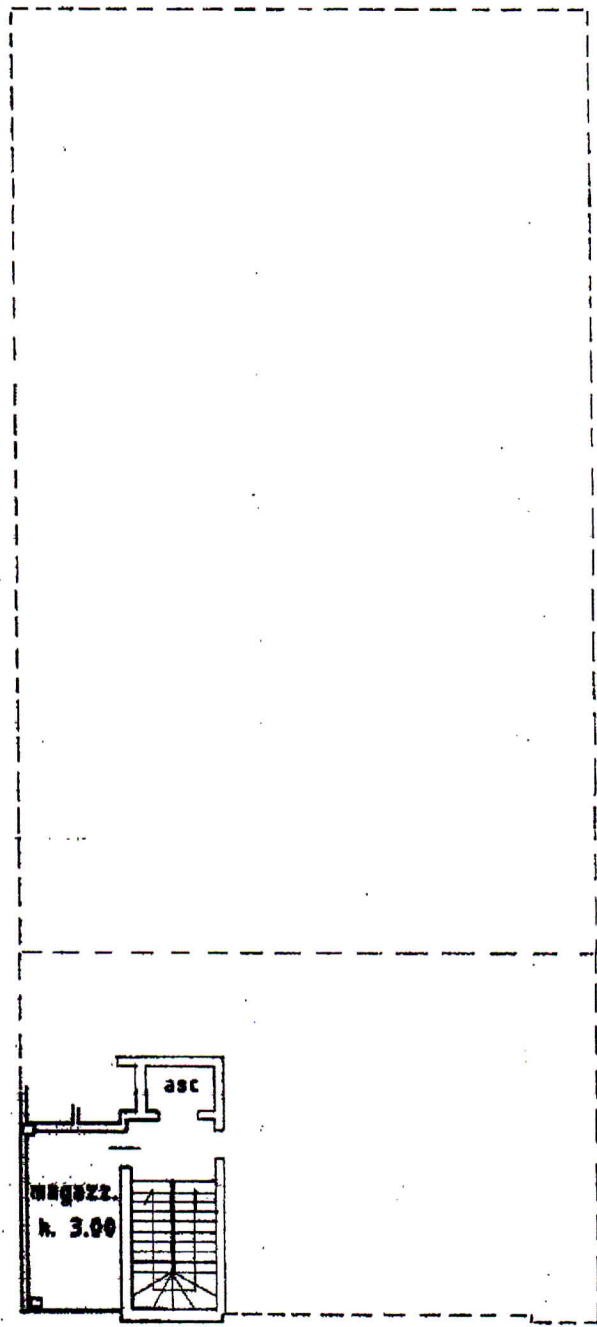

PIANO SECONDO

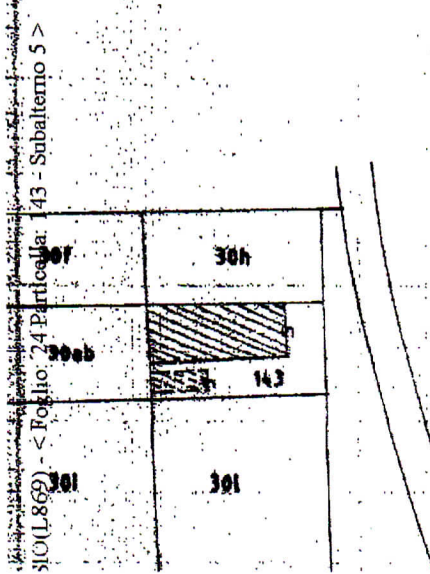

ORIENTAMENTO







Agenzia del Territorio  
**CATASTO FABBRICATI**  
Ufficio Provinciale di  
Verona

**ELABORATO PLANIMETRICO**

Compilato da:  
Vitale Federico

Sub:  
Iscritto all'albo:  
Geometri

Prov. Verona

N. 02457

Comune di Vigasio

Sezione: Foglio: 24

Particella: 143

Protocollo n. VR0384812 del 27/11/2013

Tipo Mappale n. del

Dimostrazione grafica dei subalterni

Scala 1 : 500

Catasto dei fabbricati - Situazione al 29/04/2014 - Comune di VIGASIO (VR869) - < Foglio: 24 Particella: 143 - Elaborato planimetrico

PIANO SCANTNATO

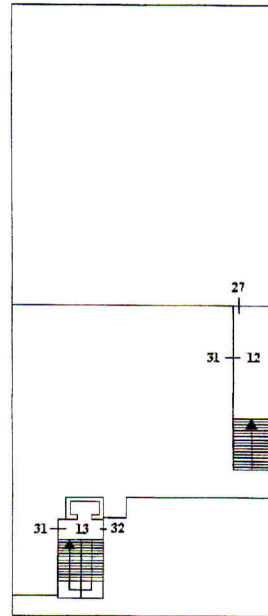
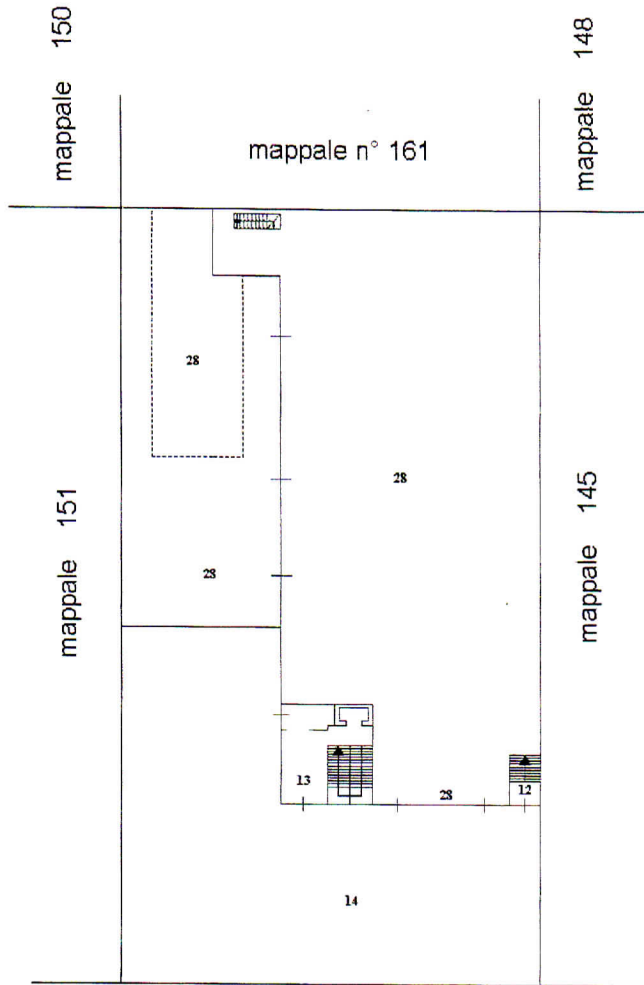
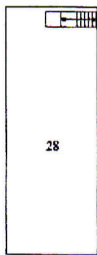

PIANO PRIMO

Via Trevenzuolo

PIANO TERRA

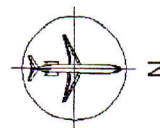

Ultima Planimetria in atti

**ELABORATO PLANIMETRICO**

Compilato da:  
Vitale Federico

Iscritto all'albo:  
Geometri

Prov. Verona N. 02457

**Agenzia del Territorio  
CATASTO FABBRICATI  
Ufficio Provinciale di  
Verona**

Comune di Vigasio

Protocollo n. VR0384812 del 27/11/2013

Sezione: Foglio: 24

Particella: 143

Tipo Mappale n. del

Dimostrazione grafica dei subalterni

Scala 1 : 500

**PIANO SECONDO**

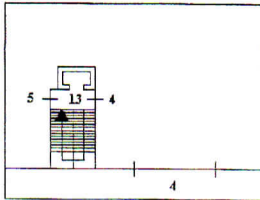

**PIANO QUARTO**

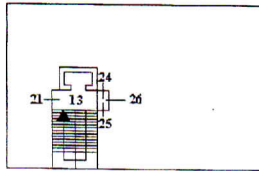

**PIANO SESTO**

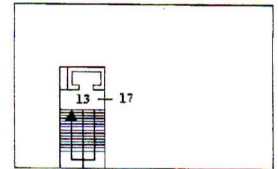

**PIANO TERZO**

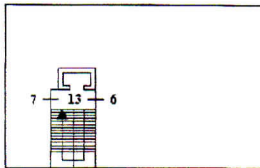

**PIANO QUINTO**

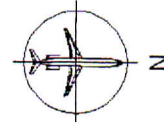
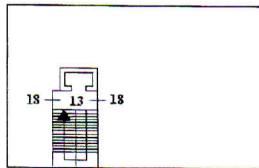

Catasto dei fabbricati - Situazione al 29/04/2014 - Comune di VIGASIO(L869) - < Foglio: 24 Particella: 143 - Elaborato planimetrico

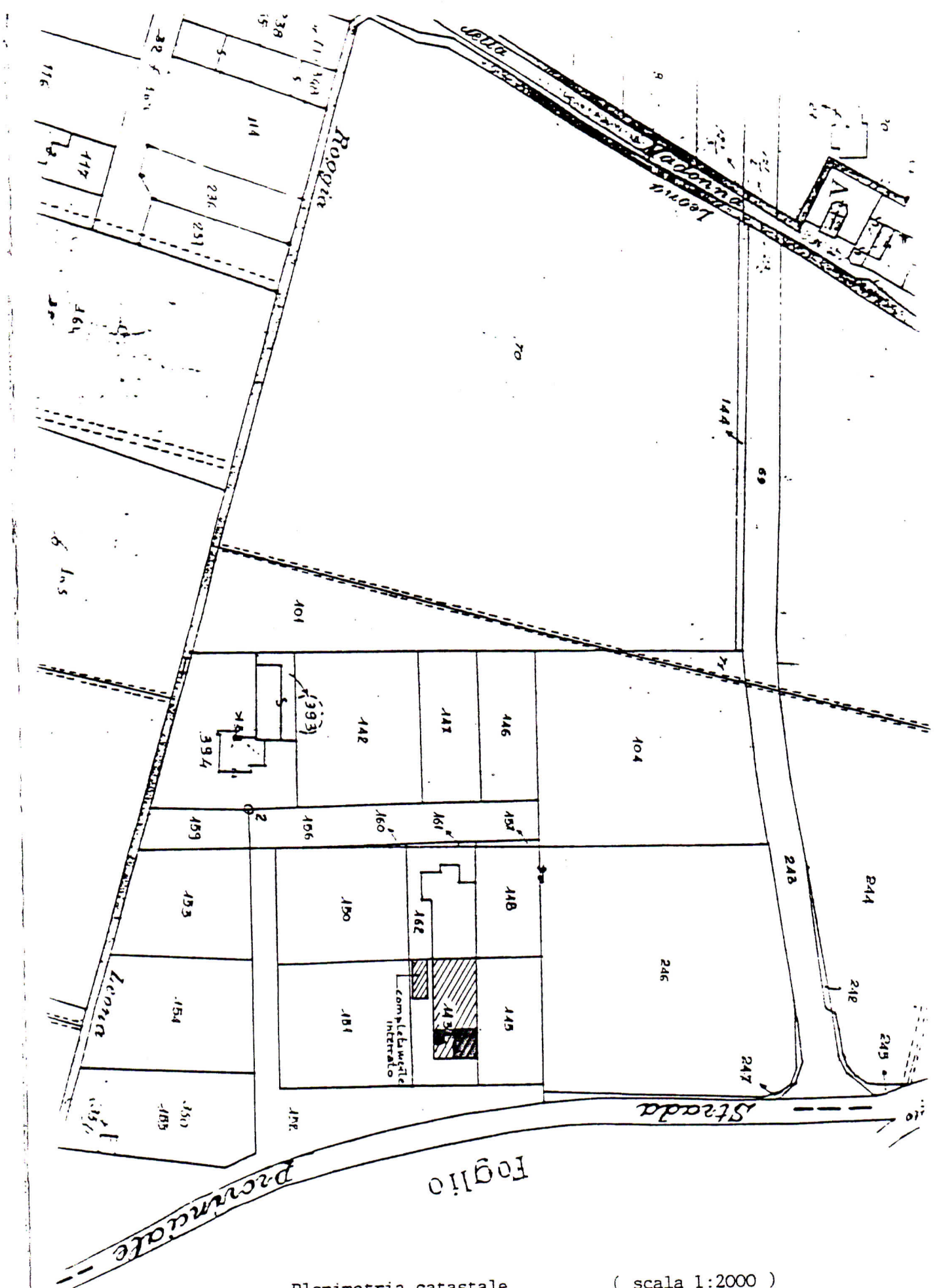

Planimetria catastale

( scala 1:2000 )

Estratto di mappa : Comune di Vigasio F. 24 mapp. n. 143  
immobile oggetto d'intervento : n. 143 sut

ESTRATTO CARTOGRAFIA P. di F. : CAPOLUOGO

LEGENDA :

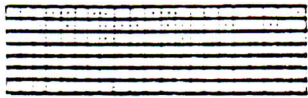

zona **A1** - VINCOLATA STORICA - VOLUMI ESISTENTI

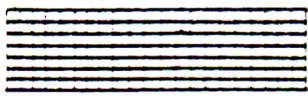

» **A2** - RESIDENZIALE URBANA - MC MQ 3,00

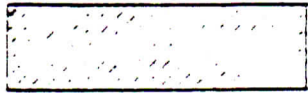

» **B1** - RESIDENZIALE INTENSIVA - MC MQ 3,00



» **B2** - RESIDENZIALE SEMINTENSIVA - MC MQ 2,00



» **B3** - RESIDENZIALE SEMIESTENSIVA - MC MQ 1,50



» **C1** - RESIDENZIALE ESTENSIVA - MC MQ 1,50

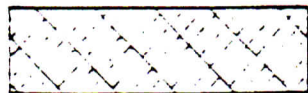

» **D** - ARTIGIANALE - INDUSTRIALE -

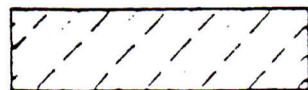

» **F1** - VERDE ATTREZZATO - MC MQ 1,50 -

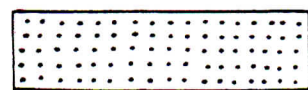

» **F2** - VERDE NOTEVOLE - INEDIFICABILE



» **E** - AREA RURALE - MC MQ 0,03









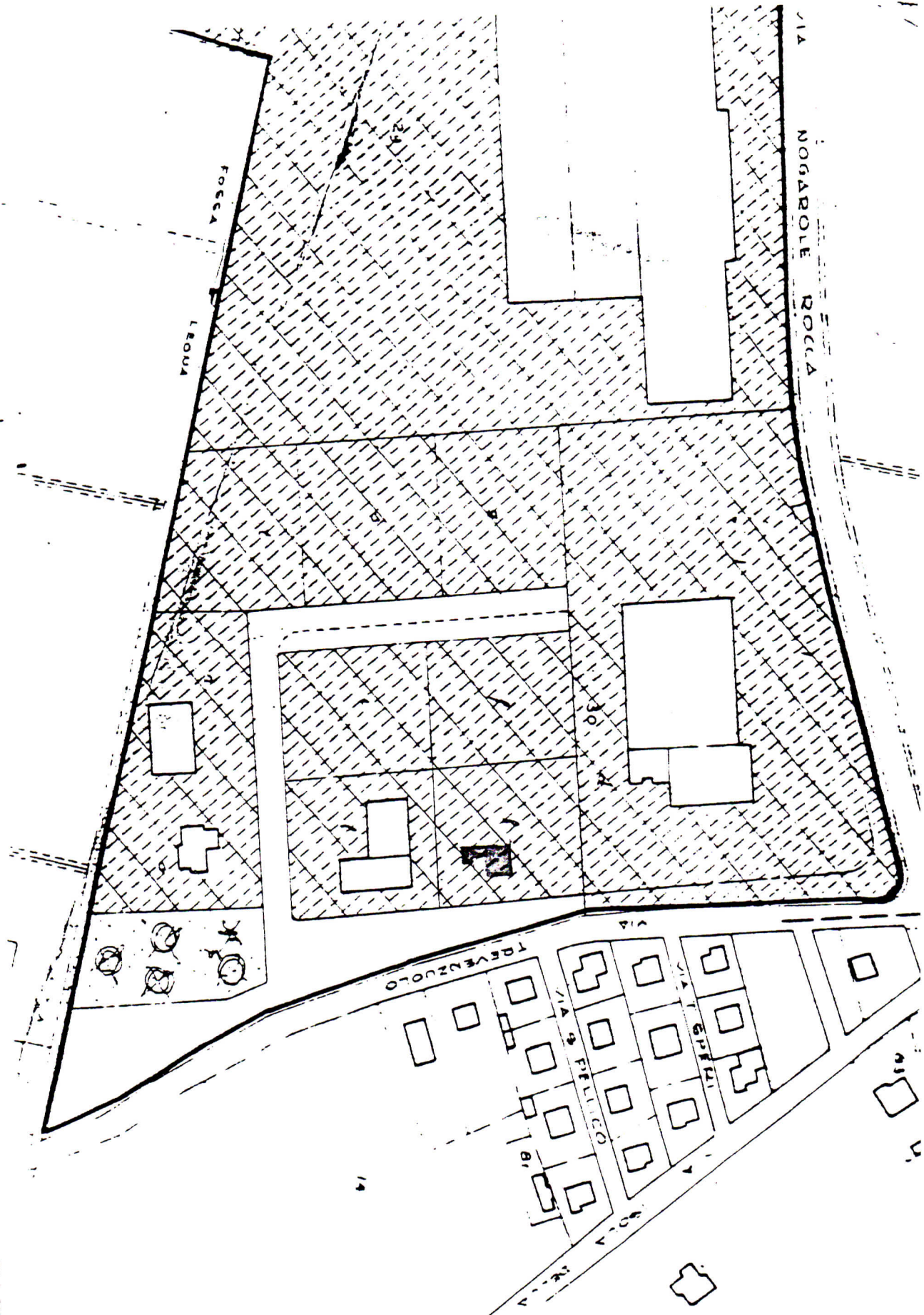





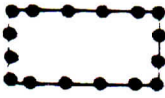

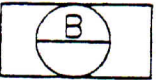
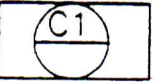
localizzazione immobile ( scala 1:2000 )

Zona D : Artigianale - industriale

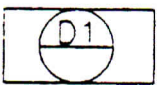

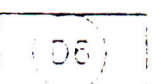
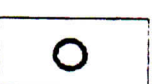

LEGENDA :

	ZONA OMOGENEA "A" - CENTRO STORICO
	PIANO DI RECUPERO
	BENI CULTURALI E AMBIENTALI ( L.R. 24/85 )
	ZONA "B" - COMPLETAMENTO EDILIZIO i.f. 1,50
	ZONA "C1" - COMPLETAMENTO EDILIZIO i.f. 1,0
	ZONA "C1S" - EDILIZIA - SPECIALE i.f. 0,50
	ZONA "C2" - ESPANSIONE RESIDENZIALE i.f. 1,0
	ZONA "C2" - ESPANSIONE RESIDENZIALE PEEP i.f. 1,2
	PIANO ATTUATIVO VIGENTE
	ZONA "D1" - INDUSTRIALE,ARTIGIANALE,COMMERCIALE DI COMPLETAMENTO
	ZONA "D2" - INDUSTRIALE,ARTIGIANALE DI ESPANSIONE
	ZONA "D3" - DIREZIONALE E COMMERCIALE DI COMPLETAMENTO
	ZONA "D4" - DIREZIONALE E COMMERCIALE DI ESPANSIONE
	ZONA "D5" - AGRO-ALIMENTARE
	ZONA "D6" - INDUSTRIALE DI ESPANSIONE
	ATTIVITA' PRODUTTIVE SITE FUORI ZONA DA CONFERMARE
	ATTIVITA' PRODUTTIVE SITE FUORI ZONA DA BLOCCARE E/O DA TRASFERIRE



localizzazione immobile ( scala 1:2000 )

Zona omogenea : Piano attuativo vigente PA 2

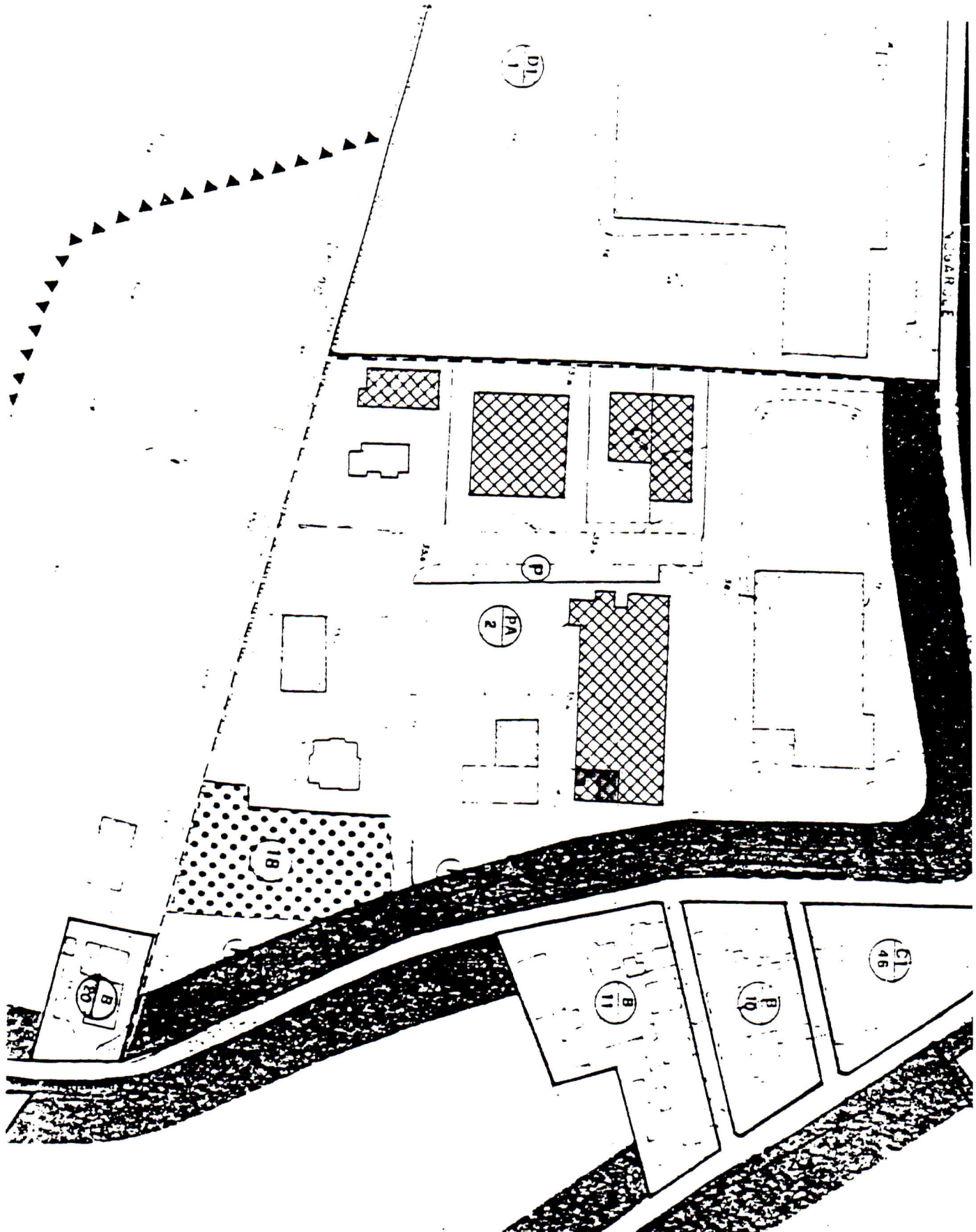

# STATO di VARIANTE

Scala 1 : 100

## Piano secondo

H = 3.00 m



Opere costruite

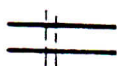

foro  $\phi$  100 mm per aerazione forzata WC

PROSPETTI e SEZIONI  
NON subiscono variazioni



# ANTE

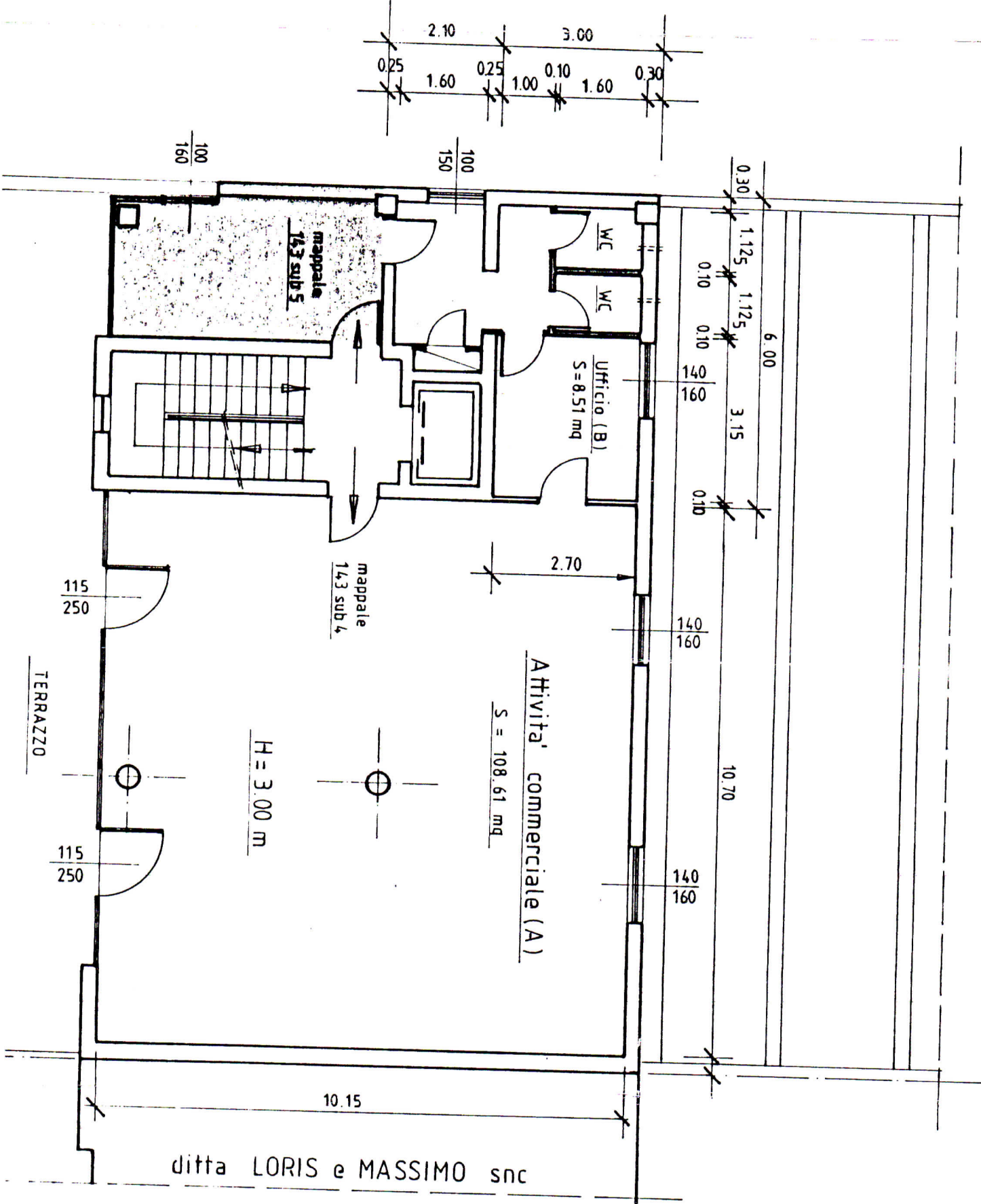

ditta LORIS e MASSIMO snc

WC

PROPR. SCAPPI DONATO E GIULIANO

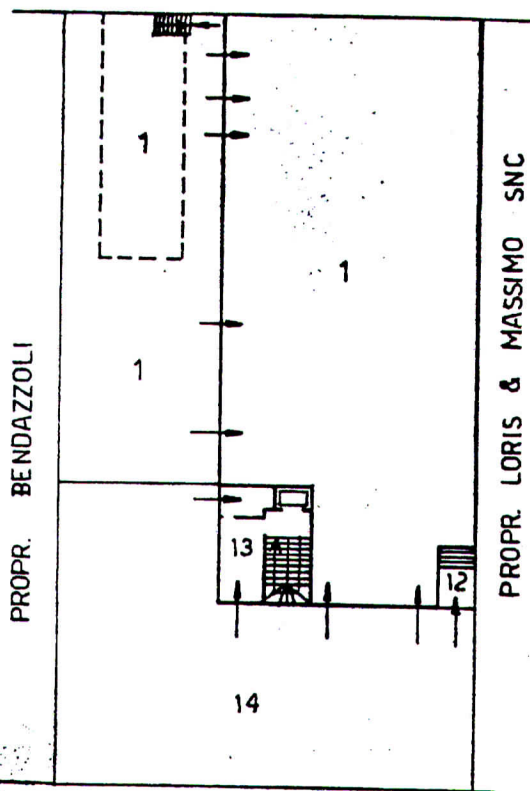

VIA TREVENUOLO

PIANO TERRENO

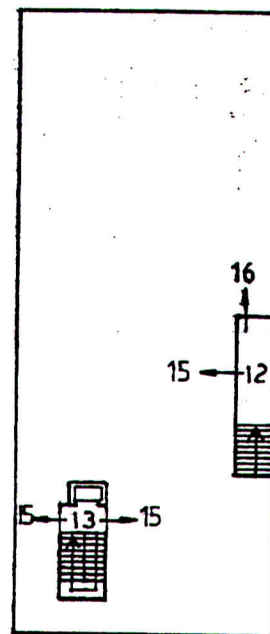

PIANO PRIMO

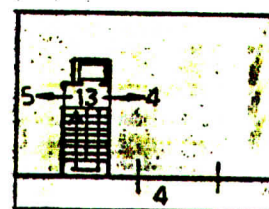

PIANO SECONDO

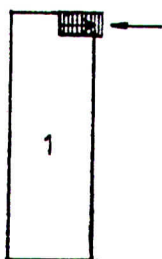

PIANO INTERRATO

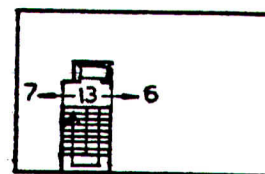

PIANO TERZO

